

## ADDENDUM #5

(drawing revision #6)

---

**PROJECT:** 5656 WATERMAN

**DATE OF ISSUE:** 2017.08.25

**OWNER:** K.C. ELLIOT

**TO:** Altman Charter Company  
BC Construction  
Reicon Constructors

**FROM:**

Jeff McGee  
St. Louis Design Alliance, Inc.  
6014 Delmar Blvd.  
St. Louis, MO 63112  
(314) 863-1313

**RE:** Addendum No. 5 to the Drawings and Specifications of the material and labor to be used and employed in construction of:

**Complete Renovations to the  
Existing Apartment Building at 5656 Waterman**

This Addendum forms a part of the bidding documents and modifies the original bidding documents previously issued.

This Addendum supersedes all conflicting portions of the Drawings and Specifications. The Contractor shall include all omissions, additions and adjustments of all trades as may be necessary because of each change, substitution or omission.

This Addendum and accompanying drawings will be distributed to General Contractors through FTP site.

## REVISIONS AND CLARIFICATIONS TO DOCUMENTS

---

**GENERAL ITEMS:** Remove alternate #7

A3.1 - As part of the base bid sump pumps shall be added as shown.

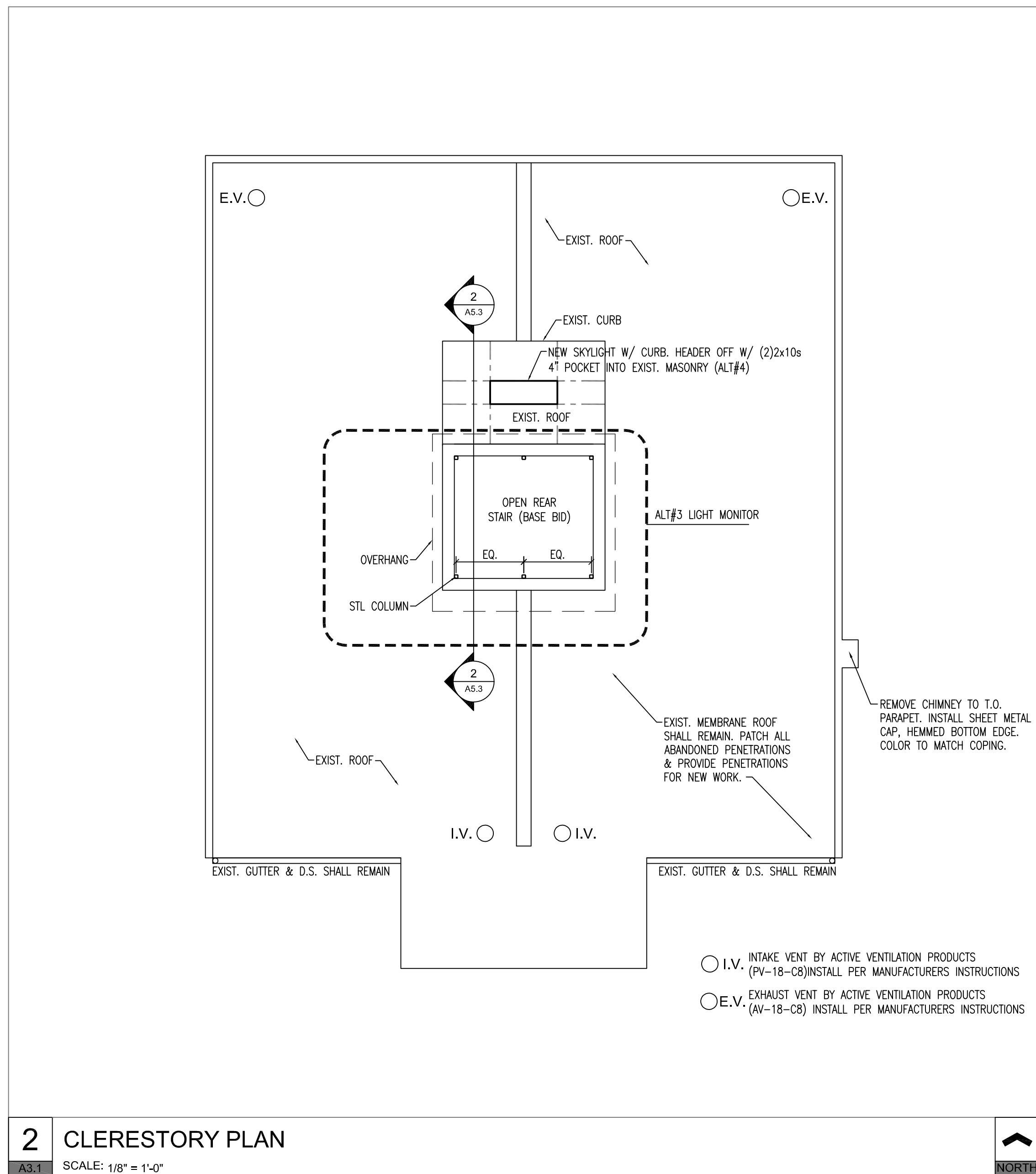

**2** CLERESTORY PLAN

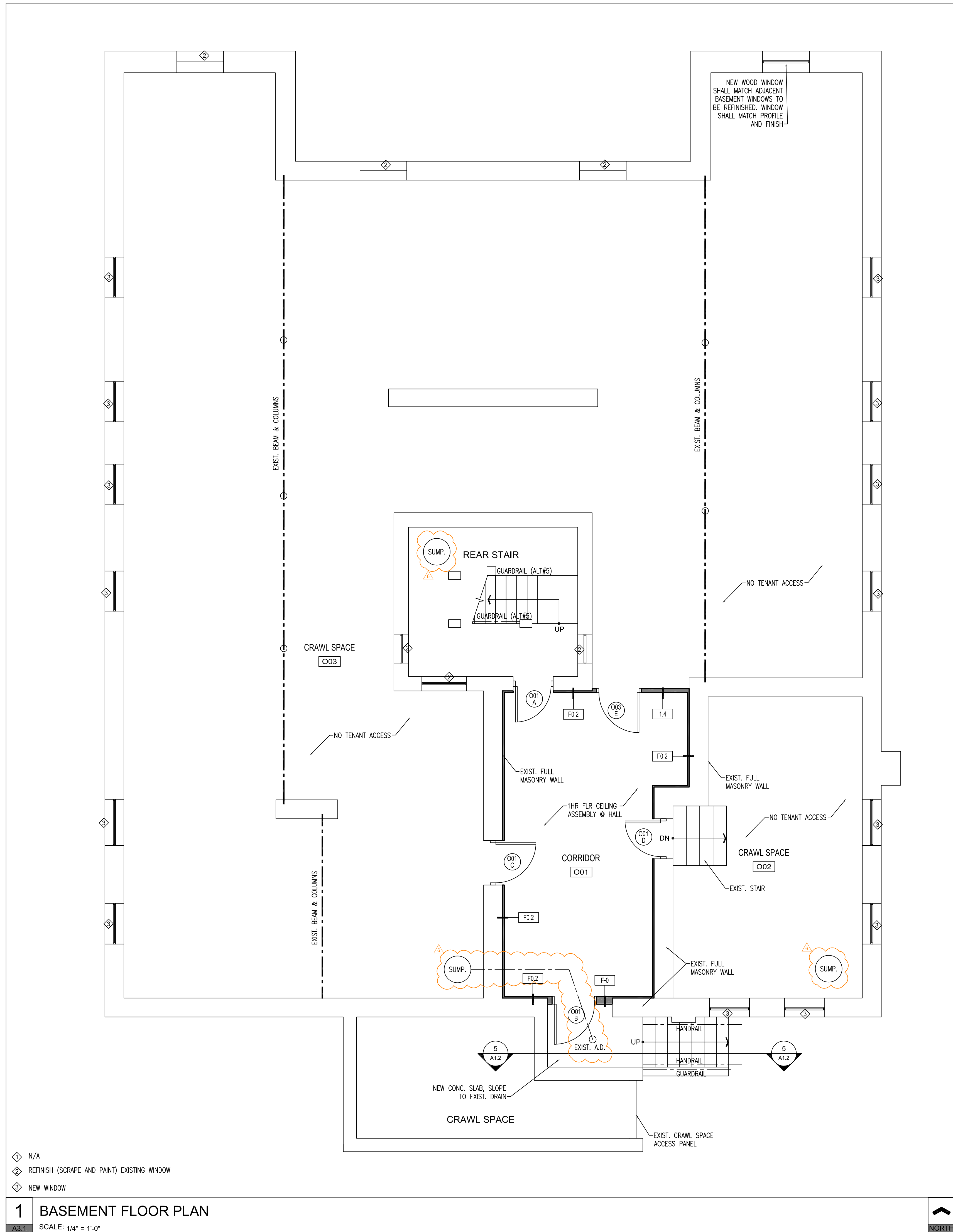

**1** BASEMENT FLOOR PLAN



**RENOVATION TO  
5656 WATERMAN  
PROJECT STREET ST. LOUIS, MO 63112**

DAVID MASTIN - ARCHITECT  
MO# A-3920

8/25/2017 2:08 PM

shaint louis  
**DESIGN ALLIANCE**  
architects

Corporation License No. 200905739  
6814 Drexel Ave. Suite 100, St. Louis, MO 63112  
PHONE 314.863.1313 FAX 314.863.1369 email: shaint@shaint.com

COMM	2017026
ISSUE	2017.07.07
DATE	SET
2017.08.25	ADD#5

SHEET TITLE  
BASEMENT AND ROOF  
PLAN

**A3.1**

NOTIFY ARCHITECT IN EVENT OF DISCREPANCIES, OMISSIONS, AND/OR CONFLICTS IN THE DRAWINGS OR SPECIFICATIONS. THE CONTRACTOR IS NOT AUTHORIZED TO SCALE THE DRAWINGS. ALL QUESTIONS IN REFERENCE TO THE CONTRACT DOCUMENTS SHALL BE IMMEDIATELY DIRECTED TO THE ARCHITECT.